

B19 UTILITY PURETIC POWERBLOCK

19 Utility Powerblocks

Motors:

B19 Utility Powerblocks are available with either hydraulic or pneumatic drive motors.

Sheaves:

Standard sheaves are rubber coated with raised cleats. Rubber filled sheaves with custom machine grooves are also available.

Powergrip:

The addition of an optional powergrip can increase traction as it will put pressure on the hose, lead or line that is being retrieved for more positive grip by the sheave. A number of different styles of grips are available. Powergrip tire rims are galvanized for long service life in a saltwater environment.



Standard diving/utility 19

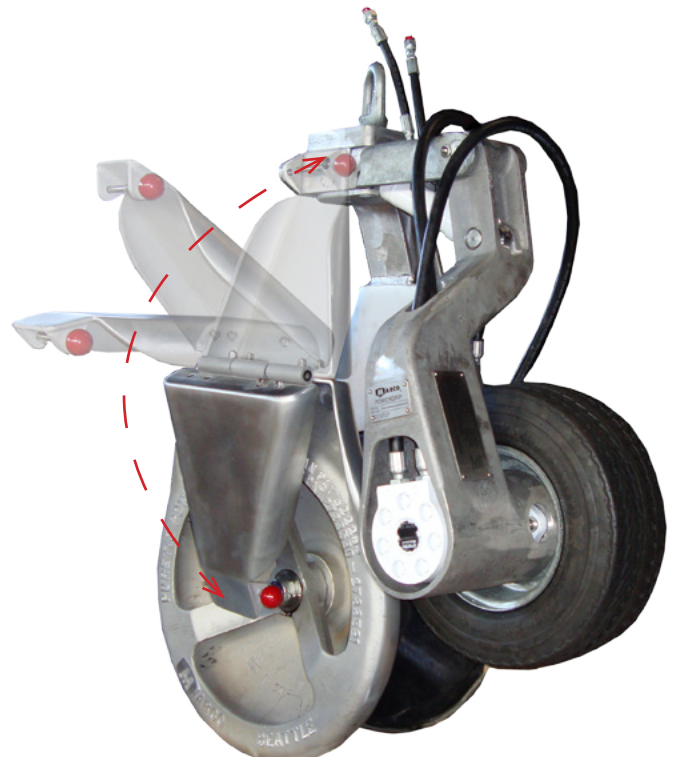

19 with hinging sideshell & standard Powergrip

Model	Weight LBS	Height Inches
B19 No Powergrip Hydraulic Motor	148	41
B19 With Powergrip and Hydraulic Motor	220	41
B19 No Powergrip Pneumatic Motor	150	41

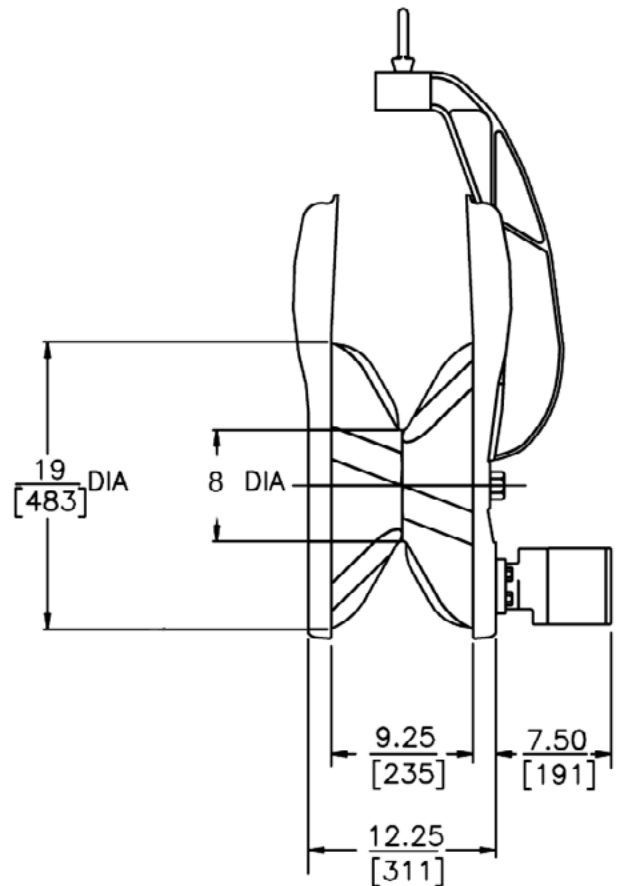
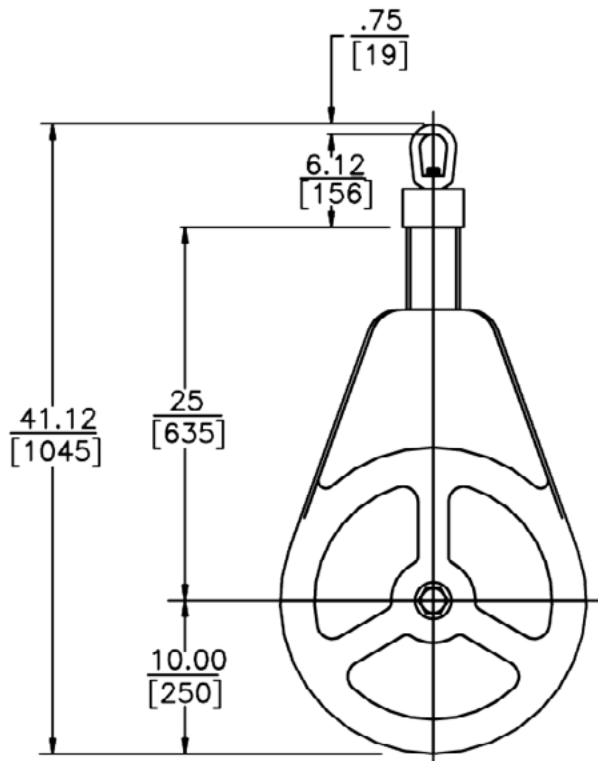

Model	Sheave Speed		Pull in LBS @ 1/2 Radius	Input	
	FPM	RPM		Flow	Pressure PSI
B19E Hydraulic Motor	200	62	2000	15 GPM	1500
B19H Pneumatic Motor	175		340 / 245	40 CFM*	90 / 65**

* CFM = Cubic Feet per Minute

** PSI of air pressure

Smith Berger Marine, Inc.

7915 10th Ave. S., Seattle, WA 98108 USA

Tel. 206.764.4650 - Toll Free 888.726.1688 - Fax 206.764.4653

E-mail: sales@smithberger.com - Web: www.smithberger.com