

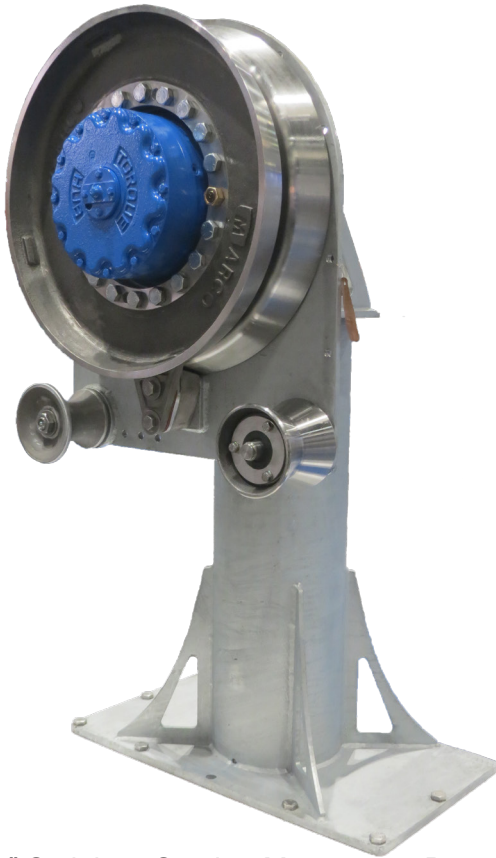

J0115 BLACK COD POT LINE HAULER



24" Stainless Steel or Manganese Bronze sheaves are adjustable with shims for use with 5/8" to 1-1/4" size line.

Galvanized fabricated steel frame for increased strength and long service life.

Low maintenance, sealed, oil lubricated Planetary Gear Drive.

Stainless steel fairlead roller with sealed lubricated ball bearings.

Galvanized fabricated steel fairlead horn.

Adjustable cross port relief valve is a standard option on the block.

Up to 8,000 pounds of line pull.

Proven Performance Through the Decades.

The Standard of Excellence

Marco originated the self powered pot hauler for the Alaska crab fisheries, making the KingHauler the industry's standard of excellence. Our Blackcod pot longline hauler uses the same sheaves and power train as the KingHauler, so we know our newest hauler will provide the same performance and reliability as the classic workhorse, the KingHauler.

Power, Speed and Reliability

The MARCO J0115 Blackcod Pot Line Hauler handles line knots and links easily, reduces line wear, and delivers superior line pull and speed. Combine it with a line bin coiler or take up reel to efficiently haul your buoyline and groundline.

No Substitutes

When you're looking for the right equipment as you switch from hook and line to longlining blackcod pots, take a close look at what we offer. There are no substitutes for a KingHauler. Remember, too, that you can always get parts and service for a KingHauler, regardless of the model or its age.

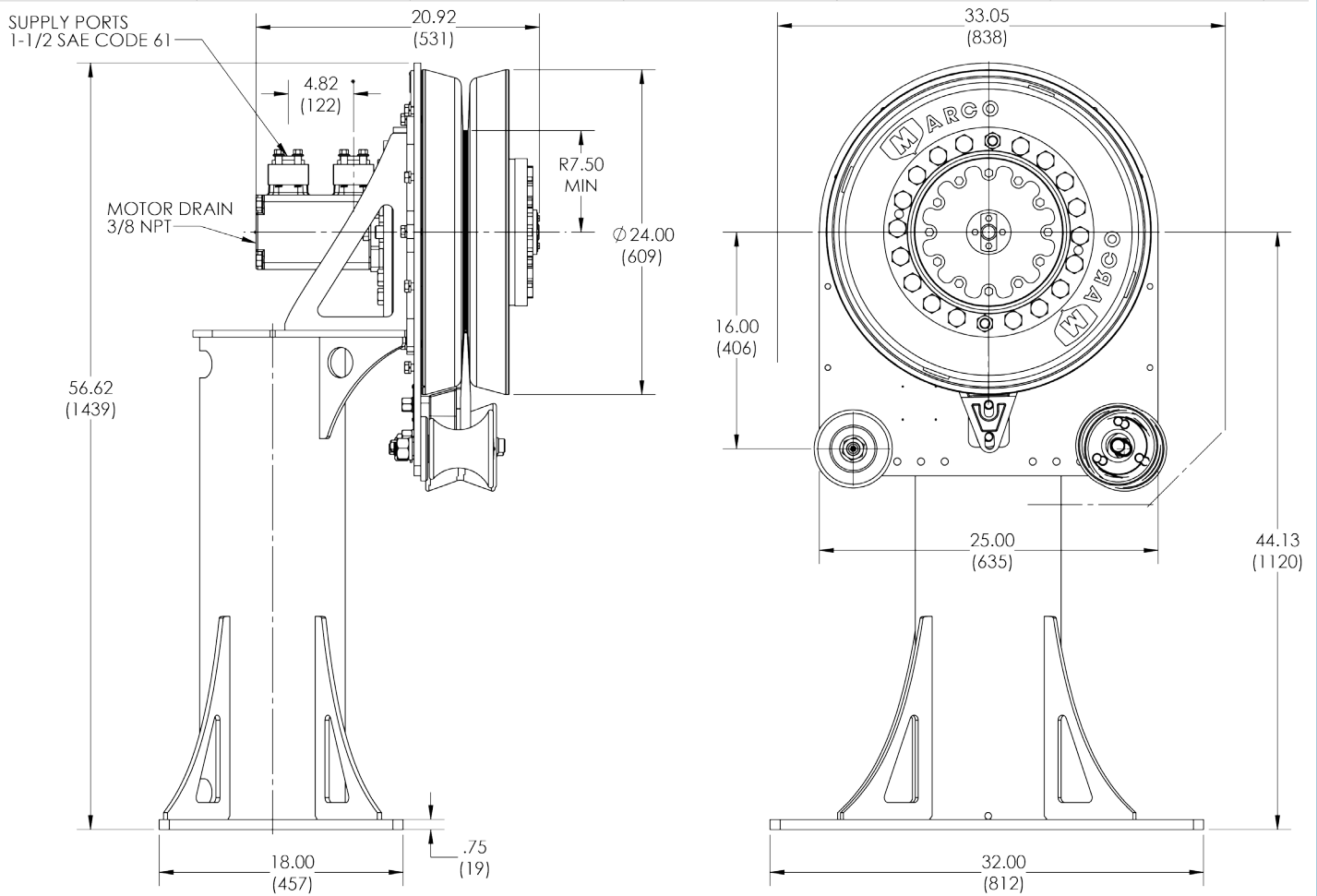

Specifications are based on hydraulic flow of 60 GPM at 2000 PSI

Motor	Torque	RPM	Pull	Velocity	Pull	Velocity
35M80	1510	2550	2580	700	3440	528
35M95	1830	2100	3130	580	4170	435
35M115	2260	1720	3860	475	5150	356
18:1 Gear Reducer					24:1 Gear Reducer	
Optional Hi-Torque W6 Gear Train					8000	114

Maximum Recommended Line Size is 1 1/4" diameter. Sheaves are adjustable with shims to accommodate line sizes from 5/8" to 1 1/4"

Construction:	Frame:	Galvanized Steel
	Sheaves:	Stainless Steel or Manganese Bronze
	Idler Sheaves:	Stainless with Ball Bearings
	Splitter	Stainless Steel
Weight:	820 Lbs.	

4259 22nd Ave. W. Seattle, WA 98199
 Phone: (206) 285-3200 Fax: (206) 282-8520
 sales@marcoglobal.com
 www.marcoglobal.com